

| 1 | | 2 | | | | 3 | | | | 4 | | | |
|--------|--------|--------|--------|--------|--------|--------|--------|--------|-----|-----|--------|--------|-----|
| SIZES | F/F | A | B | C | Ø D | E | I | L | Ø M | Ø N | Ø Q | SQ | Ø W |
| TLRNC. | ± 2.00 | APPROX | APPROX | APPROX | ± 2.00 | ± 2.00 | ± 3.00 | APPROX | - | - | APPROX | ± 0.20 | - |
| 100 | 52 | 140 | 90 | 56 | 100 | 86 | 14 | 160 | 50 | 6.5 | 149 | 11 | 150 |
| 125 | 56 | 163 | 111 | 56 | 125 | 113 | 19 | 160 | 70 | 8.3 | 176 | 14 | 215 |
| 150 | 56 | 176 | 122 | 56 | 150 | 141 | 19 | 160 | 70 | 8.3 | 207 | 14 | 215 |
| 200 | 60 | 219 | 161 | 56 | 200 | 191 | 25 | 160 | 70 | 8.3 | 260 | 17 | 215 |

- DESIGN STANDARD :- API609 | IS13095 | BS5155
- TESTING STANDARD :- API598
- FACE TO FACE STANDARD :- API609 | IS13095 | BS5155
- END CONNECTION :- Wafer to suite ANSI 150 Class, BS Table D & E IDIN PN 10 & 16

| HYDRO TEST PRESSURE | |
|---------------------|-----------------------|
| PRESSURE RATING | PN 10 |
| BODY TEST | 15 Kg/cm ² |
| SEAT TEST | 11 Kg/cm ² |

NOTES / REMARKS

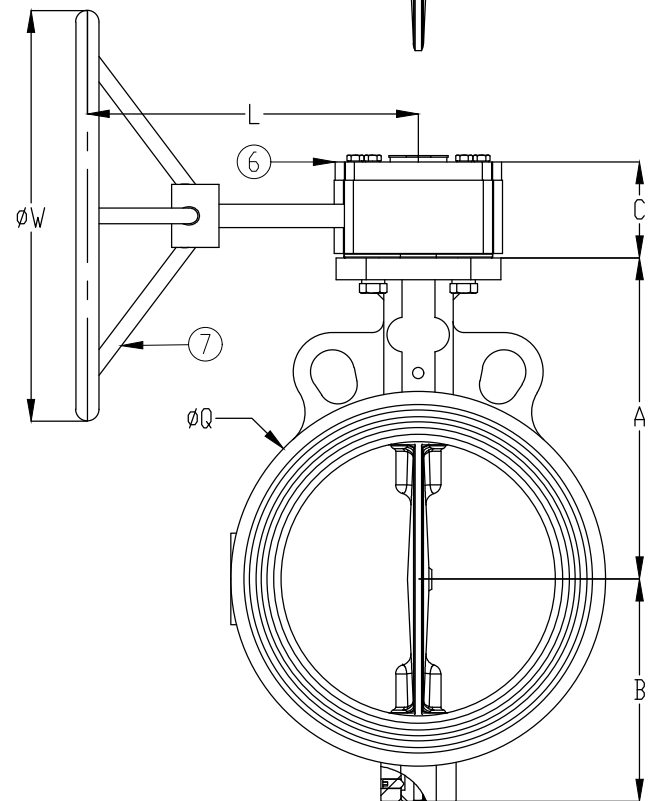
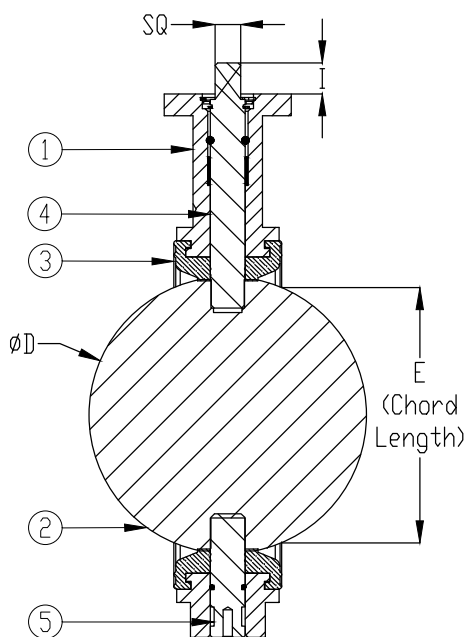
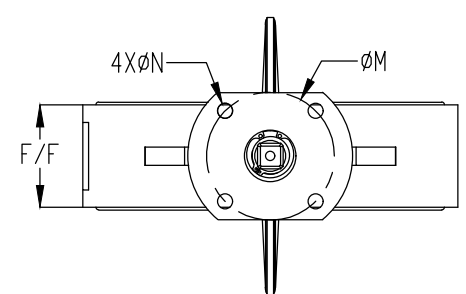

| NO. | DESCRIPTION | MATERIAL | QTY. |
|-----|--------------|--------------------------------------|------|
| - | FASTNERS | M.S. | - |
| 7 | HANDLE WHEEL | M.S. | 1 |
| 6 | GEAR BOX | Cast Iron Housing | 1 |
| 5 | PIN | SS410 | 1 |
| 4 | SHAFT | SS410 | 1 |
| 3 | SEAT | EPDM (Replaceable) | 1 |
| 2 | DISC | SG/WCB/CF8/CF8M/AL Bronze/SPL Metals | 1 |
| 1 | BODY | Cast Iron / SG Iron | 1 |

| | | | | |
|--|--|--|------|------------|
| All dimensions are in mm | | | APP. | MINESH |
| Scale:- Not to scale | | | DATE | 20-03-2021 |
| TITLE :- Wafer Type Centric Disc Replaceable Seat Butterfly Valve G.D. | | | CHK. | MINESH |
| DRG. NO. :- BFV-WAF-REP-GD-100-200 | | | DATE | 19-03-2021 |
| | | | DRN | MASUM |
| | | | DATE | 18-03-2021 |

SHREENATH ENGINEERING
MOBILE :- +91 9825530462, 9979082211
E-mail : neconvalves@yahoo.com
Website : www.neconvalves.com

| | | | | |
|--|-------------------------------|--------|------------|---------------|
| R2 | | | PROJECT :- | DATE:- |
| R1 | UPDATED LAYOUT AND DIMENSIONS | MINESH | 05/01/2022 | CUSTOMER :- |
| REV. | DESCRIPTION | APP.BY | DATE | INQUIRY NO :- |
| | | | | P.O. NO. :- |
| We reserve all rights to make any changes due to continuous improvement in process without any prior notice. | | | | |