

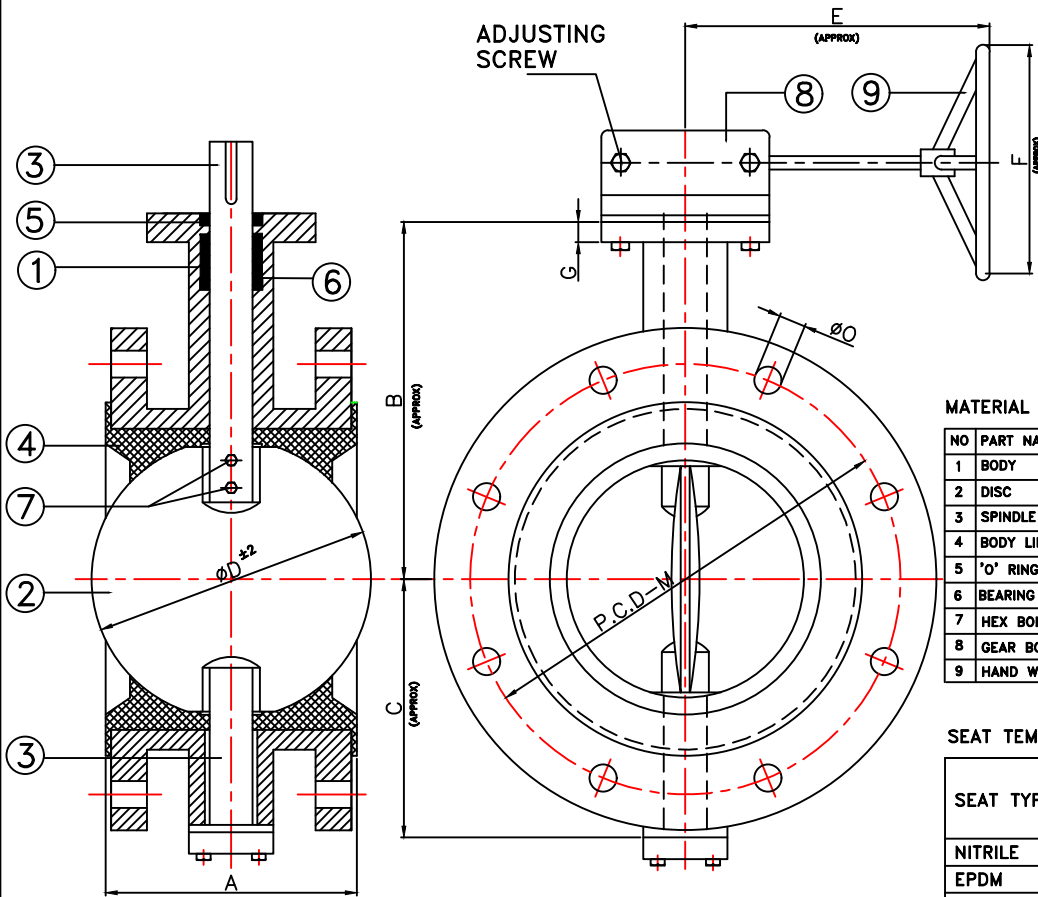

SHREENATH ENGINEERING

PLOT NO-B/22, ZAVERI ESTATE,
NR. KATHWADA G.I.D.C., KATHWADA-SINGARVA ROAD,
KATHWADA, AHMEDABAD-382 430, GUJARAT, INDIA.
MOBILE :- +91 9825530462, 9979082211
E-mail: info@neconvalves.com / Website : www.neconvalves.com

DRN ABDUL	DATE 10/06/2024	
DOUBLE FLANGE CENTRIC DISC TYPE BUTTER FLY VALVE.		
DRG. NO : SE/DF-BFV/GO/700-900		



NOTE : ALL DIMENSION ARE IN MM.

SIZE		A	B	C	D	E	F	G	M	N	O	TOP FLANGE MOUNTING (I.S.O 5211)
MM	INCH											
700	28"	292	565	465	684	385	600	26	863.6	28	35	F16
750	30"	318	600	510	739	385	600	26	914.4	28	35	F16
800	32"	318	650	535	775	396	600	26	977.9	28	41	F25
900	36"	330	735	615	881	396	600	26	1085.9	32	41	F25

MATERIAL OF CONSTRUCTION

NO	PART NAME	MATERIAL
1	BODY	CI/SGI/WCB/CF8/CF8M/CF3/CF3M
2	DISC	CI/SGI/WCB/CF8/CF8M/CF3/CF3M
3	SPINDLE	SS 410/304/316/304L/316L
4	BODY LINING	NITRILE/E.P.D.M./SILICON/VITON/HYPALON
5	'O' RING	NITRILE / E.P.D.M.
6	BEARING BUSH	PTFE
7	HEX BOLT	S.S.304/316
8	GEAR BOX	CAST IRON
9	HAND WHEEL	M.S. FABRICATED

SEAT TEMPERATURE RANGE

SEAT TYPE	TEMPERATURE RANGE	
	Min.	Max.
NITRILE	-13°F(-25°C)	212°F(100°C)
EPDM	-13°F(-25°C)	250°F(120°C)
SILICON	-58°F(-50°C)	356°F(180°C)
VITON	-23°F(-5°C)	392°F(200°C)
HYPALON	-4°F(-20°C)	250°F(120°C)

TESTING

PRESSURE RATING	HYDROSTATIC SHELL TEST		HYDROSTATIC SEAT TEST	
	Kg/CM2	PSI	Kg/CM2	PSI
PN10	15	210	10	140
PN16	22	310	16	225

CONFORMITY TO CODES & STANDARDS

- GENERAL DESIGN & MANUFACTURE :- BS 5155 / IS 13095
- VALVE FACE TO FACE DIMENSION :- BS 5155 / IS 13095
- TOP FLANGE DRILLING :- ISO 5211
- VALVE INSPECTION & TESTING :- BS 6755 Part - I / API 598
- FLANGE STANDARD CONFORMITY :- ANSI 150 / ANSI 125

THIS DRAWING IS PROPERTY OF SHREENATH ENGINEERING.
SHREENATH ENGINEERING RESERVES RIGHTS OF USE,CHANGE & MODIFY PRODUCT DESIGN OR PRODUCT WITHOUT PRIOR NOTICE.

CHECKED :-

APPROVED :-